

If you have a computer with multiple monitors, the display settings will need to match the physical setup of the monitors for the mouse pointer to move smoothly from monitor to monitor.

To adjust your display settings, right click on any open area of your computer's desktop.

Select Display settings.

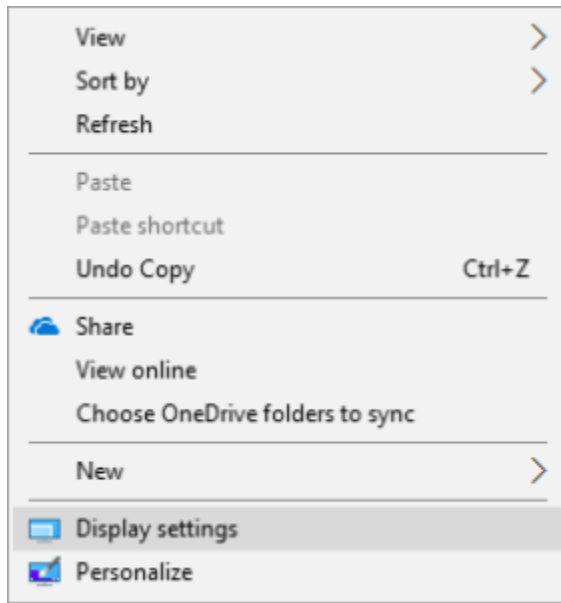

In the Display Settings window, you can identify which monitor is which by clicking on Identify.

Settings

SYSTEM

Find a setting

Display

Notifications & actions

Apps & features

Multitasking

Tablet mode

Power & sleep

Storage

Offline maps

Default apps

About

Customize your display



[Identify](#) [Detect](#)

A custom scale factor is set. [Turn off custom scaling and sign out](#)

Change the size of text, apps, and other items: 175%

Orientation

Landscape

Multiple displays

Extend these displays

Make this my main display

Apply Cancel

[Advanced display settings](#)

A number 1 or 2 will display momentarily on each monitor. Note that the physical layout of the monitors must match the display on your computer. If it doesn't, click and drag the monitor to match the physical layout. You will need to click *Apply* before the changes take effect. If the mouse moves in the opposite direction of what you expect (moving the mouse to the right causes it to move to the left instead), swap the *monitors* in the display settings.

When you have multiple monitor displays, you can change the display to

- Show on both at the same time (duplicate)
- Extend to both (or all) of them
- Show on only one

Extending is the most common setting and allows full function of both monitors.

Display

Notifications & actions

Apps & features

Multitasking

Tablet mode

Power & sleep

Storage

Offline maps

Default apps

About

Customize your display



[Identify](#) [Detect](#)

A custom scale factor is set. [Turn off custom scaling and sign out](#)

Change the size of text, apps, and other items: 175%



Orientation

Landscape

Duplicate these displays

Extend these displays

Show only on 1

Show only on 2

Apply

Cancel

[Advanced display settings](#)